

1986 WENMAN DRIVE

Saanich





FOR SALE



1986 Wenman Dr

Saanich

SUMMARY OVERVIEW



LISTING PRICE: \$1,549,000



LOT AREA 0.22 acres



LIVING AREA: 2,600 square feet



BEDROOMS: 4



BATHROOMS: 3



Well-maintained and move-in ready, this spacious 4-bedroom, 3-bathroom home offers a functional layout designed for comfortable everyday living and effortless entertaining. Generous living and dining areas are complemented by a large family room off the kitchen, while a versatile main-floor bedroom is ideal for guests, a home office, or media room. The beautifully landscaped, fully fenced flat backyard provides exceptional privacy and a welcoming outdoor setting. A large driveway, attached double garage, and expansive crawl space offer outstanding parking and storage. Pride of ownership is evident throughout this thoughtfully cared-for home. Situated on one of Gordon Head's most desirable streets, this is a rare opportunity to own in an established neighbourhood close to Arbutus Cove, Gordon Head Park, UVic, Camosun College, Cadboro Bay, shopping, dining, trails, downtown Victoria, and more. Minutes to beaches, parks, schools, and transit in one of Victoria's premier areas. A must see!

MAIN FLOOR
1631 SQ. FT.
 8'-0" to 10'-10" CEILING HT



Property Floorplan

Main Level 1,631 sq.ft.

Second Level 969 sq.ft.

TOTAL AREA 2,600 sq.ft.

Garage 535 sq. ft.

Deck/Patio 235 sq.ft.

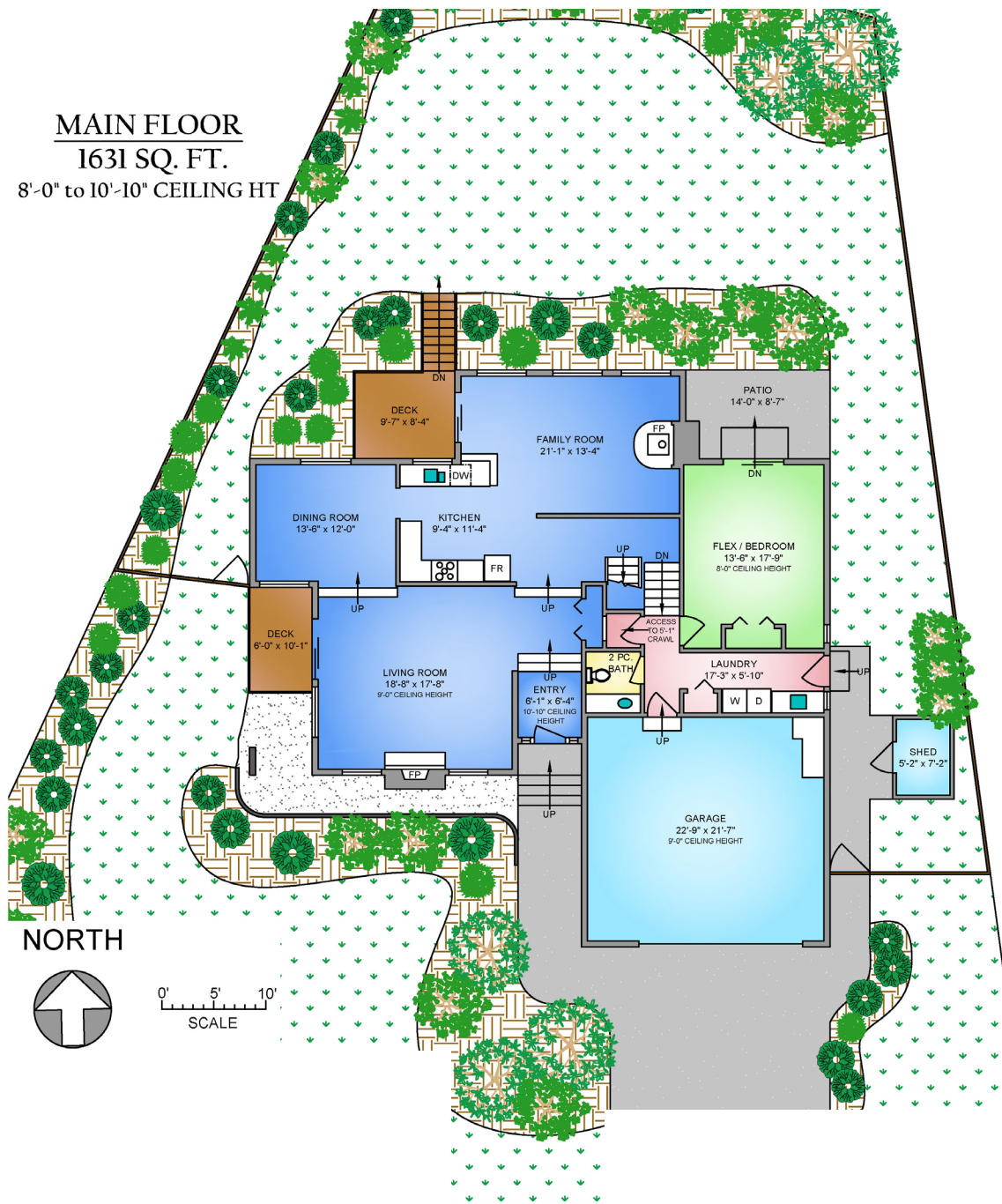

UPPER FLOOR
969 SQ. FT.
8'-0" CEILING HEIGHT



Property Floorplan

Main Level 1,631 sq.ft.
Second Level 969 sq.ft.

TOTAL AREA 2,600 sq.ft.

Garage 535 sq. ft.
Deck/Patio 235 sq.ft.

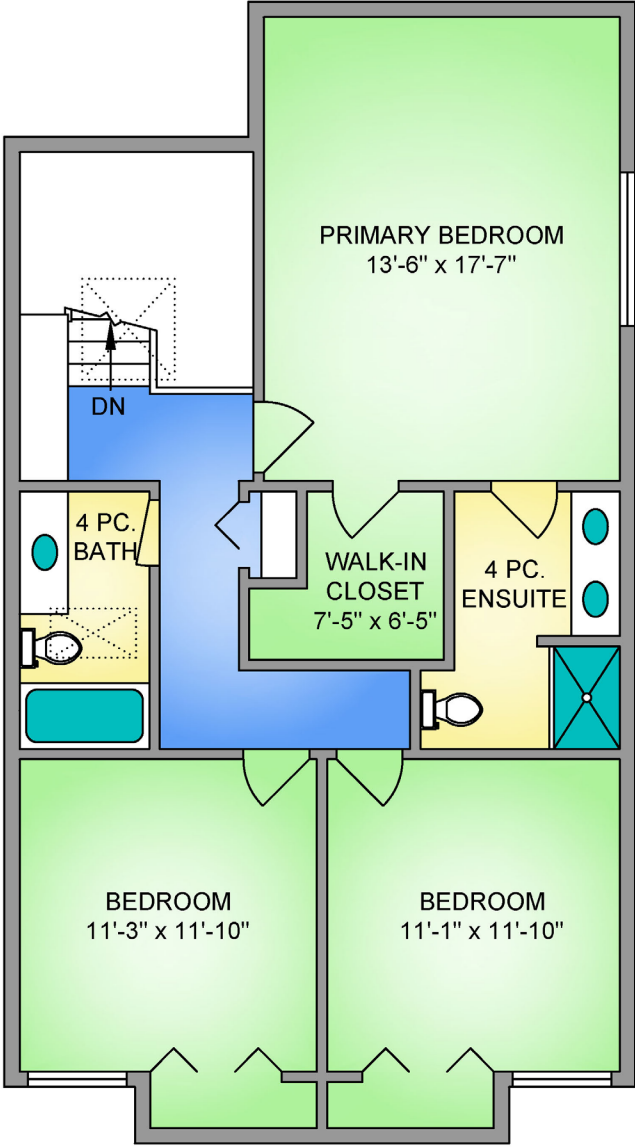



Property Photos

EXTERIOR





Property Photos

INTERIOR





Property Photos

INTERIOR





Location

(GIS) MAPPING

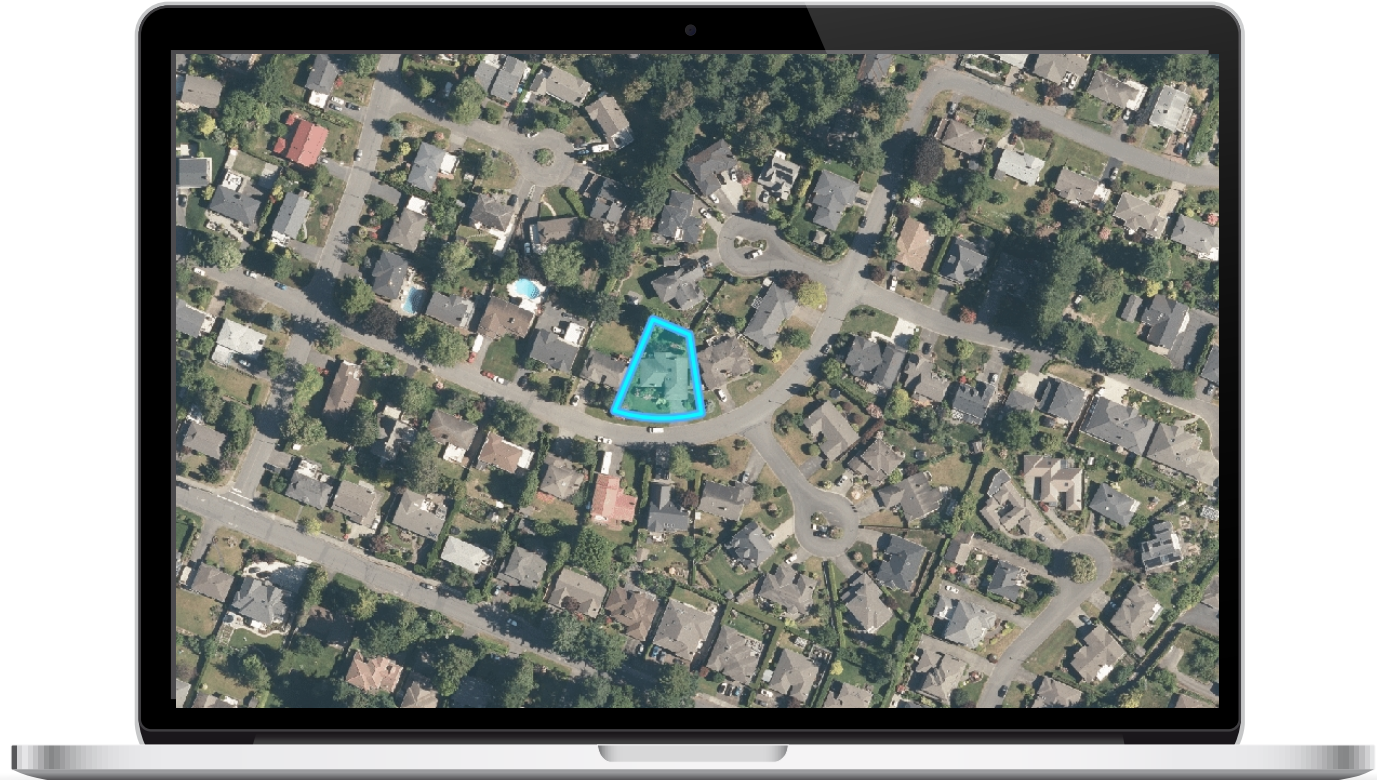

Located in the desirable northeast corner of Saanich, Gordon Head is a sought-after community known for its family-friendly atmosphere, excellent schools, and close proximity to the coastline. Surrounded by parks, beaches, and walking trails, the area offers a perfect blend of natural beauty and everyday convenience, with easy access to the University of Victoria, shopping, and downtown Victoria.



 **CHACE
WHITSON**
PERSONAL REAL ESTATE CORPORATION

Macdonald
Realty



CEL · 250 818 9338 | TEL · 778 426 2262

Chace@ChaceWhitson.com | ChaceWhitson.com

2411 · Bevan Avenue Sidney, BC · V8L 4M9





Chace Whitson | 778.250.9338 | Chace@ChaceWhitson.com | ChaceWhitson.com