



8425 LOCHSIDE

Central Saanich





FOR SALE



8425 Lochside Dr
Central Saanich

[SUMMARY OVERVIEW](#)



LISTING PRICE:	\$5,399,000
----------------	-------------



LIVING AREA:	4,019 sq. ft.
--------------	---------------



BEDROOMS:	4
-----------	---



BATHROOMS:	3
------------	---



Exceptional waterfront living on 1.09 acres. This 4-bedroom + office, 4-bathroom home captures stunning sunrises through floor-to-ceiling windows that frame panoramic views across the ocean. Built to the highest standards, the home offers a seamless indoor/outdoor lifestyle with oversized glass sliders opening onto a covered patio complete with built-in heaters—ideal for year-round entertaining. Inside, the open-concept layout is anchored by a stunning kitchen featuring Wolf and Sub-Zero appliances and a spacious walk-in pantry. A custom wine room adds a touch of elegance. The primary suite offers a private retreat with ocean views and a spa-inspired ensuite with a freestanding tub, walk-in shower, and heated floors. Every detail—from the thoughtful layout to the uncompromising craftsmanship—reflects luxurious West Coast living at its finest.



Property Floorplan

Main Floor 2,061 sq. ft.
Upper Floor 1,653 sq. ft.

TOTAL AREA 3,714 sq. ft.

Garage 1,021 sq. ft.
Deck/Patio 1,052 sq. ft.

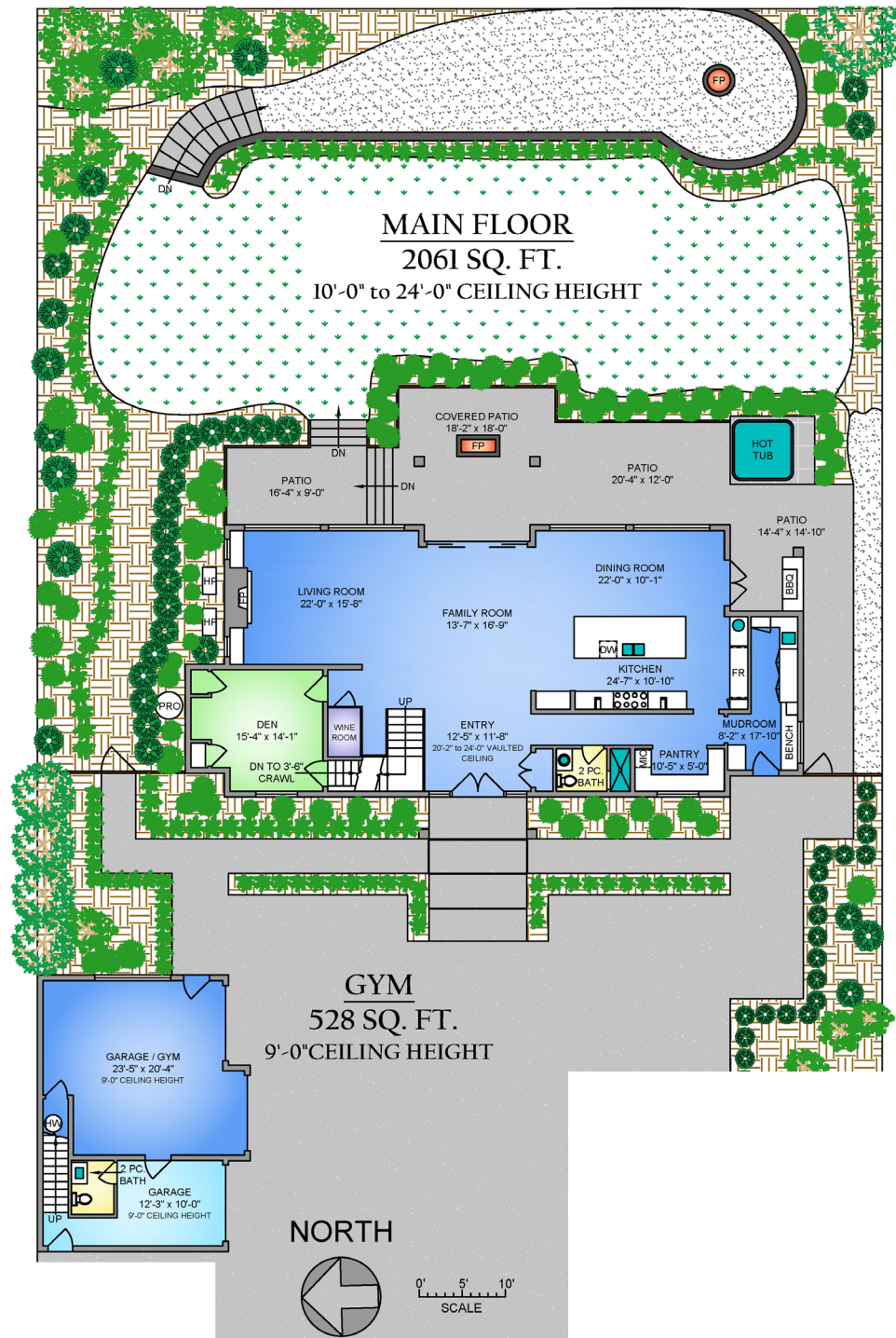

* DIMENSIONS ARE FOR REFERENCE PURPOSES ONLY AND ARE NOT TAKEN FROM ORIGINAL BLUEPRINTS



Property Floorplan

Main Floor 2,061 sq. ft.
Upper Floor 1,653 sq. ft.

TOTAL AREA 3,714 sq. ft.

Garage 1,021 sq. ft.
Deck/Patio 1,052 sq. ft.

UPPER FLOOR 1653 SQ. FT. 9'-0" CEILING HEIGHT

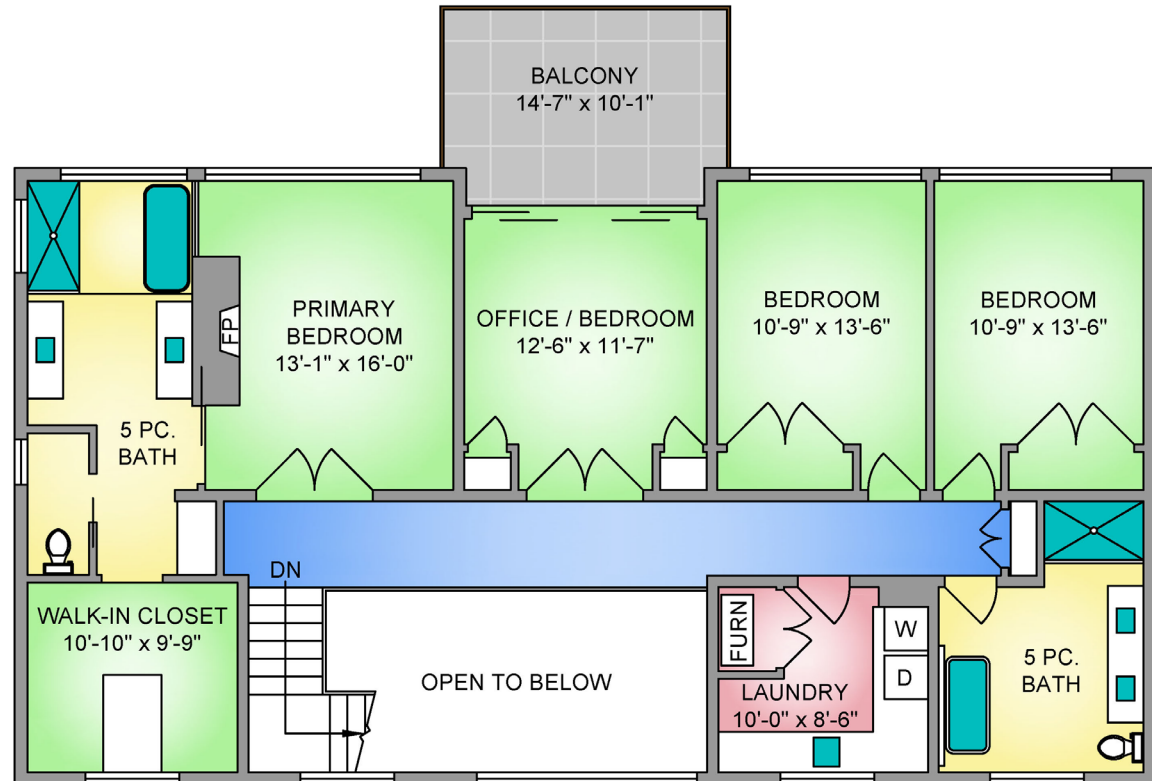

UNFINISHED GUEST SUITE 276 SQ. FT. 7'-3" to 10'-6" VAULTED CEILING

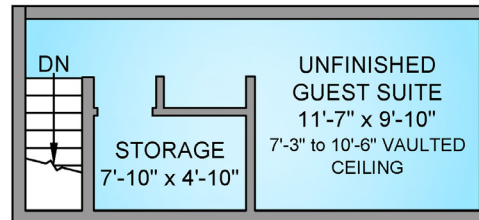

NORTH

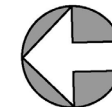

0' 5' 10'
SCALE

* DIMENSIONS ARE FOR REFERENCE PURPOSES ONLY AND ARE NOT TAKEN FROM ORIGINAL BLUEPRINTS



Property Photos

EXTERIOR





Property Photos

KITCHEN





Property Photos

INTERIOR





Property Photos

PRIMARY BEDROOM
& ENSUITE





Property Photos

EXTERIOR





Location

(GIS) MAPPING







CEL · 250 818 9338 | TEL · 778 426 2262

Chace@ChaceWhitson.com | ChaceWhitson.com

2411 · Bevan Avenue Sidney, BC · V8L 4M9





**CHACE
WHITSON**
PERSONAL REAL ESTATE CORPORATION



Chace Whitson | 250.818.9338 | Chace@ChaceWhitson.com | ChaceWhitson.com