



# 11176 CHALET

North Saanich





## 11176 Chalet Rd

SUMMARY OVERVIEW



LISTING PRICE:

\$6,250,000



LIVING AREA:

4,352 sq. ft.



BEDROOMS:

5



BATHROOMS:

3



Spectacular WATERFRONT rancher, situated on an elegantly landscaped 1.25 acres with panoramic views of Saanich Inlet! Built with uncompromised quality and impeccable attention to detail, this 4,352 sqft coastal-inspired home is designed to capture breathtaking sunsets and marine life views. Enjoy vaulted ceilings, large windows, a chef's kitchen with quartz island, Wolf gas range, shaker cabinets, and premium appliances. The primary suite offers a spa-like 5-piece ensuite and walk-in closet. Enjoy the finest outdoor living with an expansive covered patios, outdoor kitchen, and beautiful landscaping with pathways and a commercial-grade bridge. The oversized triple garage, heat pump with A/C, and metal roof add comfort and function. Nestled on the sunny west side of the Saanich Peninsula in idyllic Deep Cove—just steps from the world-renowned Deep Cove Chalet and minutes to Sidney, BC Ferries and International Airport—this private oasis offers the ultimate West Coast lifestyle, truly a one-of-a-kind property!



## Property Floorplan

Main 2,809 sq. ft.  
Lower 1,543 sq. ft.

**TOTAL AREA 4,352 sq. ft.**

Garage 947 sq. ft.  
Deck/Patio 1,097 sq. ft.

Lot Size 1.25 Acres

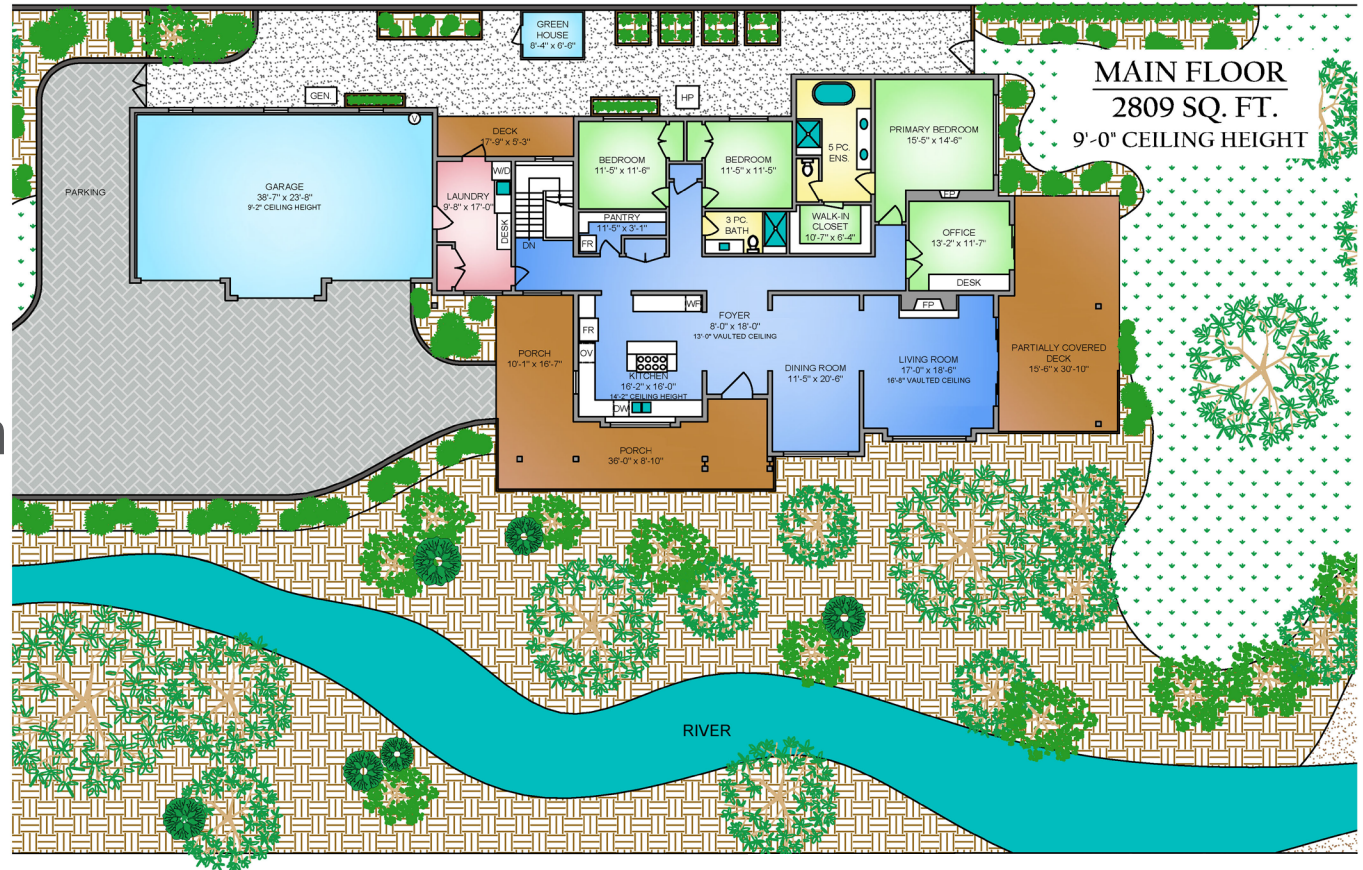

\* DIMENSIONS ARE FOR REFERENCE PURPOSES ONLY AND ARE NOT TAKEN FROM ORIGINAL BLUEPRINTS



## Property Floorplan

Main 2,809 sq. ft.  
Lower 1,543 sq. ft.

**TOTAL AREA 4,352 sq. ft.**

Garage 947 sq. ft.  
Deck/Patio 1,097 sq. ft.

Lot Size 1.25 Acres

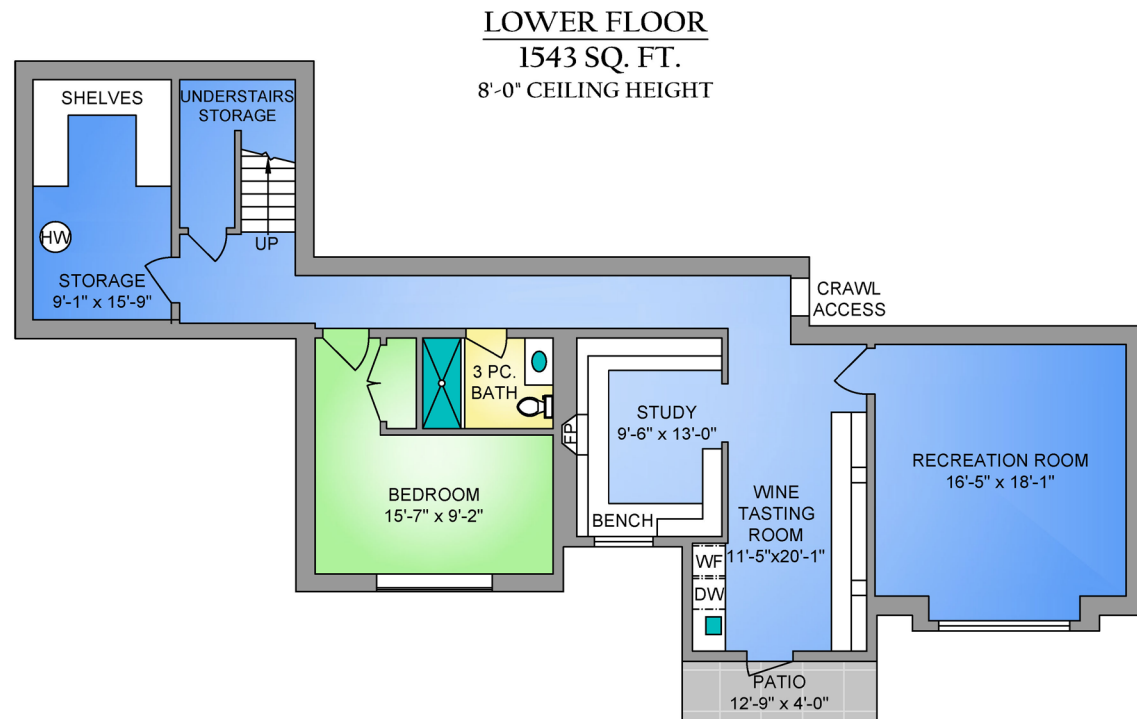

\* DIMENSIONS ARE FOR REFERENCE PURPOSES ONLY AND ARE NOT TAKEN FROM ORIGINAL BLUEPRINTS



## Property Photos

EXTERIOR





# Property Photos

## KITCHEN





## Property Photos

INTERIOR





# Property Photos

INTERIOR





# Property Photos

EXTERIOR





# Location

(GIS) MAPPING







CEL • 250 818 9338 | TEL • 778 426 2262

[Chace@ChaceWhitson.com](mailto:Chace@ChaceWhitson.com) | [ChaceWhitson.com](http://ChaceWhitson.com)

2411 • Bevan Avenue Sidney, BC • V8L 4M9





**CHACE  
WHITSON**  
PERSONAL REAL ESTATE CORPORATION



Chace Whitson | 250.818.9338 | [Chace@ChaceWhitson.com](mailto:Chace@ChaceWhitson.com) | [ChaceWhitson.com](http://ChaceWhitson.com)