



# 10210 TSAYKUM

North Saanich





FOR SALE



**10210 Tsaykum Rd**  
North Saanich

## SUMMARY OVERVIEW



LISTING PRICE:	\$2,180,500
----------------	-------------



LIVING AREA:	2,019 sq. ft.
--------------	---------------



BEDROOMS:	4
-----------	---



BATHROOMS:	3
------------	---





# Property Floorplan

TOTAL LIVING 2,019 sq. ft.

Garage 448 sq. ft.

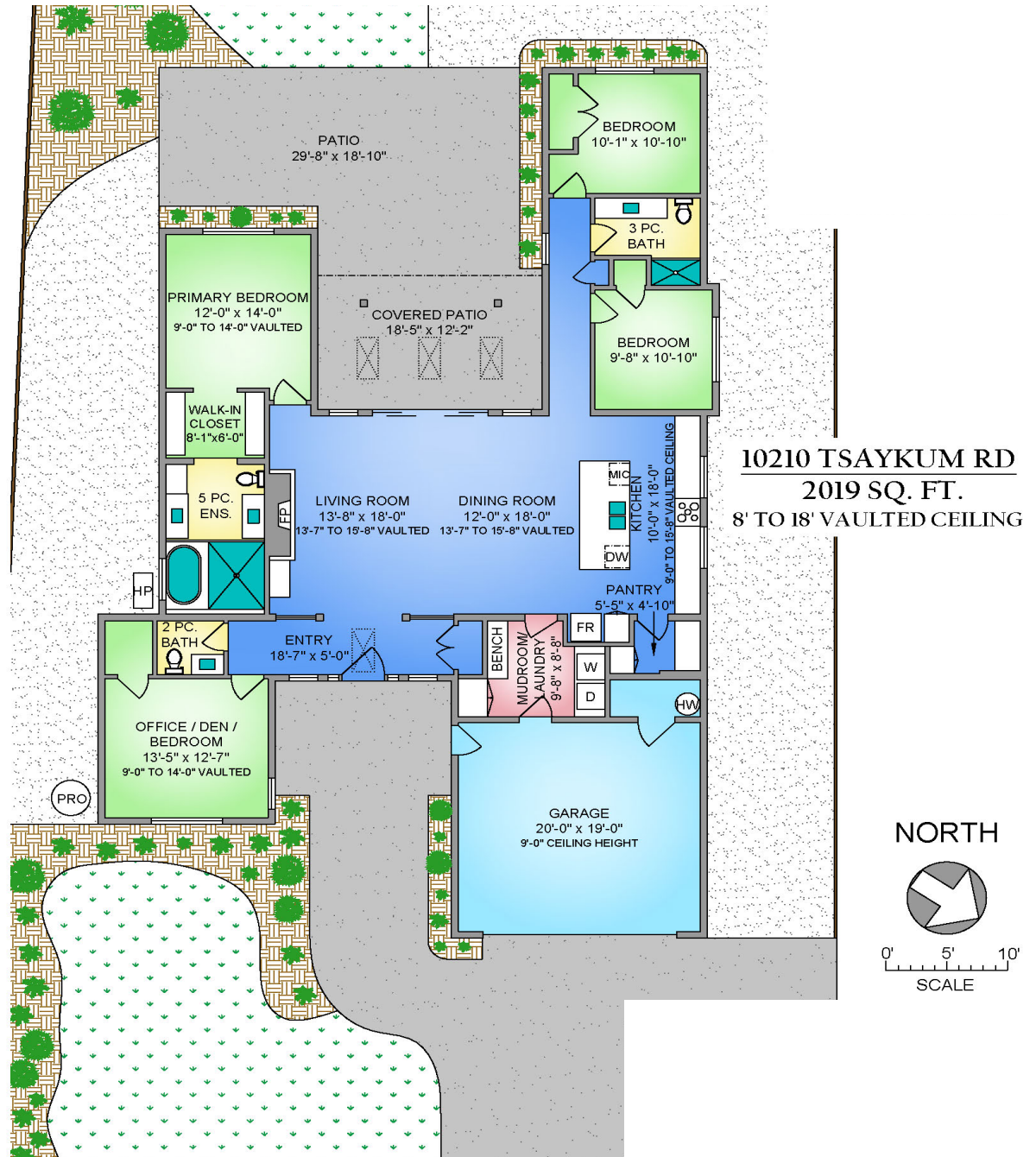

\* DIMENSIONS ARE FOR REFERENCE PURPOSES ONLY AND ARE NOT TAKEN FROM ORIGINAL BLUEPRINTS



## Property Photos

EXTERIOR



\* RENDERINGS ARE FOR ILLUSTRATION PURPOSES ONLY AND ARE SUBJECT TO CHANGE AT THE DEVELOPER'S DISCRETION





## Property Photos

### KITCHEN



\* RENDERINGS ARE FOR ILLUSTRATION PURPOSES ONLY AND ARE SUBJECT TO CHANGE AT THE DEVELOPER'S DISCRETION



# Property Photos

## LIVING ROOM



\* RENDERINGS ARE FOR ILLUSTRATION PURPOSES ONLY AND ARE SUBJECT TO CHANGE AT THE DEVELOPER'S DISCRETION





# Property Photos

INTERIOR





# Property Photos

---

## INTERIOR



\* RENDERINGS ARE FOR ILLUSTRATION PURPOSES ONLY AND ARE SUBJECT TO CHANGE AT THE DEVELOPER'S DISCRETION





## Property Photos

EXTERIOR



\* RENDERINGS ARE FOR ILLUSTRATION PURPOSES ONLY AND ARE SUBJECT TO CHANGE AT THE DEVELOPER'S DISCRETION



# Features & Finishes

## QUALITY WITHOUT COMPROMISE

- Construction Carwood Homes
- 2,019 sq.ft. of finished single level living space
- 3 bedrooms + den, 3 bathrooms
- 16 ft. vaulted ceilings in great room
- Mudroom with bench seating
- Open concept living space
- Engineered hardwood
- Hardi Plank & Board and Batten siding
- Vinyl double glazed windows
- Concrete rear patio

## GOURMET KITCHEN

- Wood cabinets w/ soft close drawer and cabinets
- Modern pendant lights
- Quartz Countertops
- Millwork pantry with pullout drawers
- Recessed under cabinet lighting
- Custom built-in hood fan
- Panel ready Fisher Paykel appliances
- Gas range

## PRIMARY BEDROOM & EN-SUITE

- Spacious walk-in closet w/ custom millwork and organizer
- Walk-in shower with frameless glass
- Free standing soaker tub
- Rain shower with removable showerhead
- In-floor radiant heating
- Right height elongated toilet
- Double sinks single-lever
- Built-in cabinets and under-mount motion sensor lighting
- 14 ft. vaulted ceiling

## ADDITIONAL CONVENIENCE

- Electric heat pump w/ air conditioning
- Pre-wired electric car charging station
- In-floor radiant heating in laundry room
- Outdoor water connections and electrical outlets
- Gas BBQ hookup
- Screens on all opening windows
- Full size laundry room with quartz counter tops and undermount sinks
- Professional low maintenance landscaping
- Crawl Space
- Double-car garage
- Baseboard heater in garage

## QUALITY CONSTRUCTION

- Homecare Program, Traveler's 2-5-10 new home warranty:

☑ *2 years material and labour*

☑ *5 year building envelope*

☑ *10 year structural*

\*FEATURES AND FINISHINGS ARE SUBJECT TO CHANGE AT THE DEVELOPER'S DISCRETION\*





## Location

(GIS) MAPPING

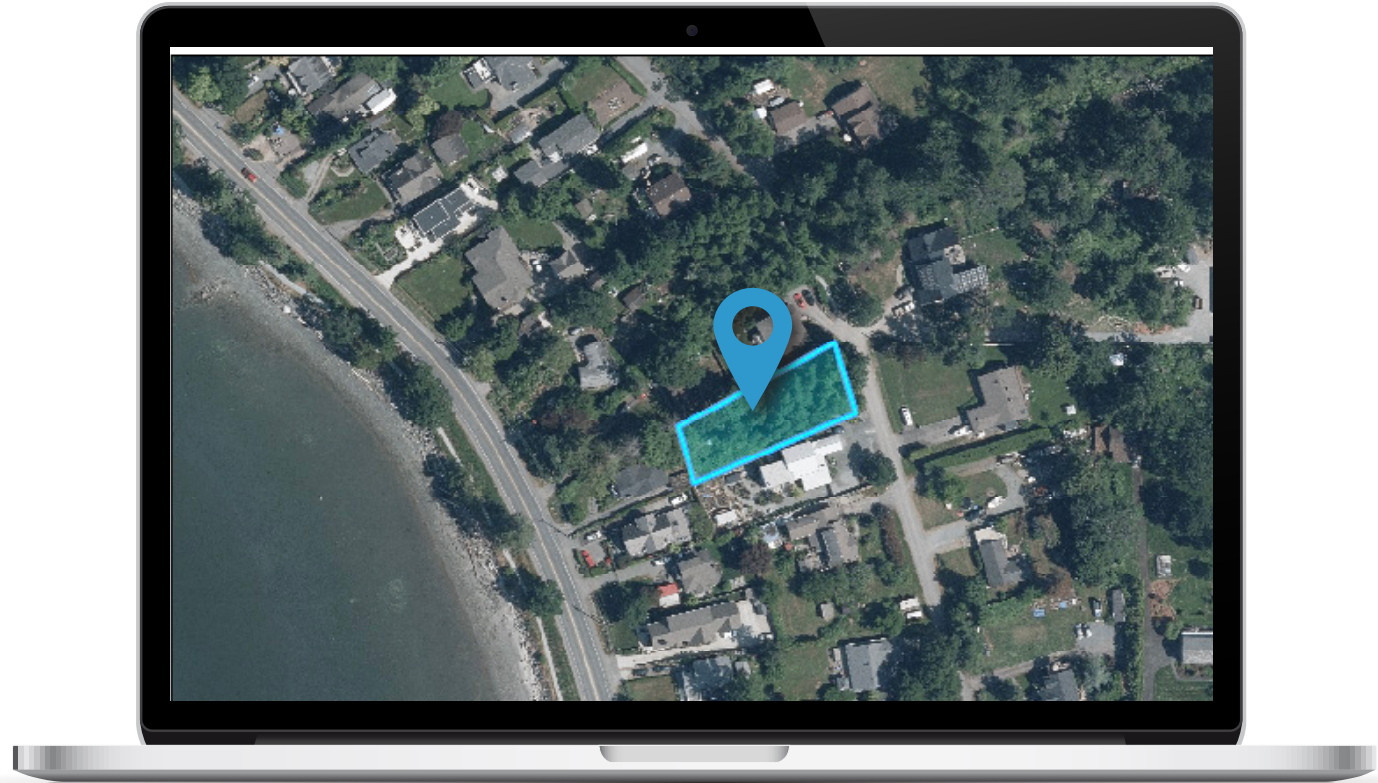









CEL • 250 818 9338 | TEL • 778 426 2262

[Chace@ChaceWhitson.com](mailto:Chace@ChaceWhitson.com) | [ChaceWhitson.com](http://ChaceWhitson.com)

2411 • Bevan Avenue Sidney, BC • V8L 4M9





Chace Whitson | 250.818.9338 | [Chace@ChaceWhitson.com](mailto:Chace@ChaceWhitson.com) | [ChaceWhitson.com](http://ChaceWhitson.com)