

# 508-7162 WEST SAANICH

Brentwood Bay





FOR SALE



# 508-7162 West Saanich Road

Brentwood Bay

SUMMARY OVERVIEW



LISTING PRICE: \$699,000



LIVING AREA: 1,056 sq. ft.



BEDROOMS: 2



BATHROOMS: 2



Stunning 1,056 sq.ft West facing penthouse, offering luxurious living in the heart of Brentwood Bay. Featuring soaring ceilings, designer finishes, and an open concept layout, this exquisite home is sure to impress. Highlights include 2 beds/2 baths, 12' vaulted ceilings, gourmet kitchen w/ quartz counters & premium KitchenAid appliances, engineered oak hardwood flooring, n/g fireplace & heat-pump w/ A/C. Step outside your doors onto a spacious North-West corner balcony, perfect for enjoying incredible sunsets and the warm evening sun. This well-appointed unit comes equipped with a secure ground level parking stall and a private storage locker. Conveniently located in the vibrant community of Brentwood Bay & walking distance to restaurants, shops & transit, this is an incredible condo, offering outstanding quality and value.

**UNIT 508 - 7162 WEST SAANICH ROAD**

**1055 SQ. FT.**

**12' to 8'-10" CEILING HEIGHT**



# Property Floorplan

**LIVING AREA** 1,056 sq. ft.

Balcony 73 sq. ft.

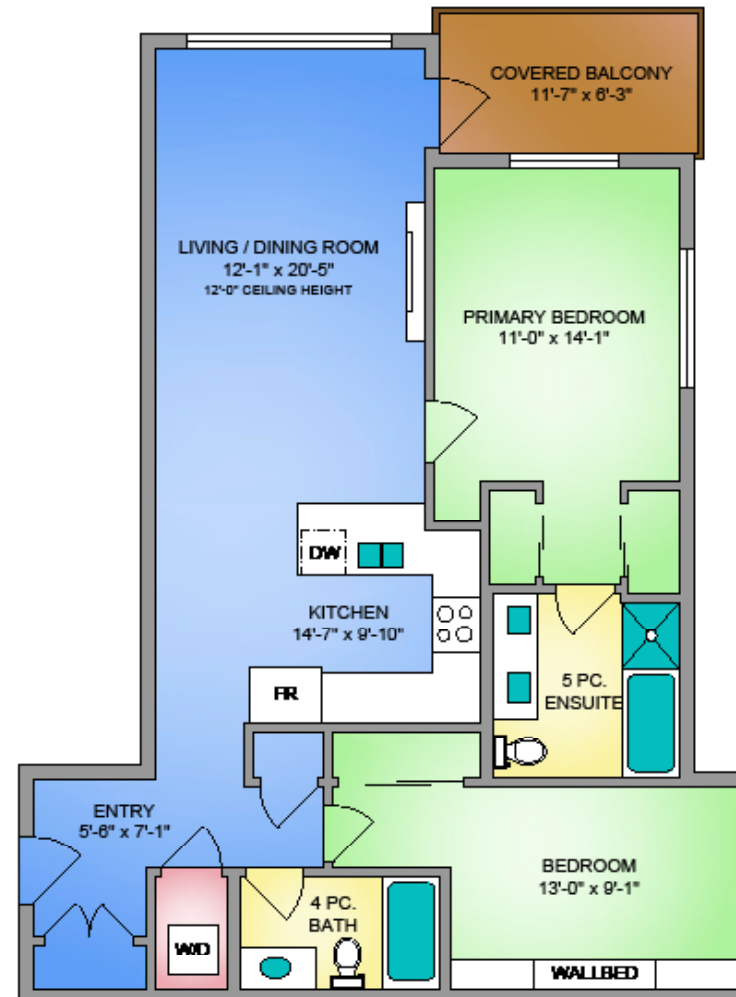

**NORTH**

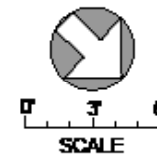

\* DIMENSIONS ARE FOR REFERENCE PURPOSES ONLY AND ARE NOT TAKEN FROM ORIGINAL BLUEPRINTS



## Property Photos

---





# Property Photos

---





## Property Photos

---





## Property Photos

---





# Location

(GIS) MAPPING

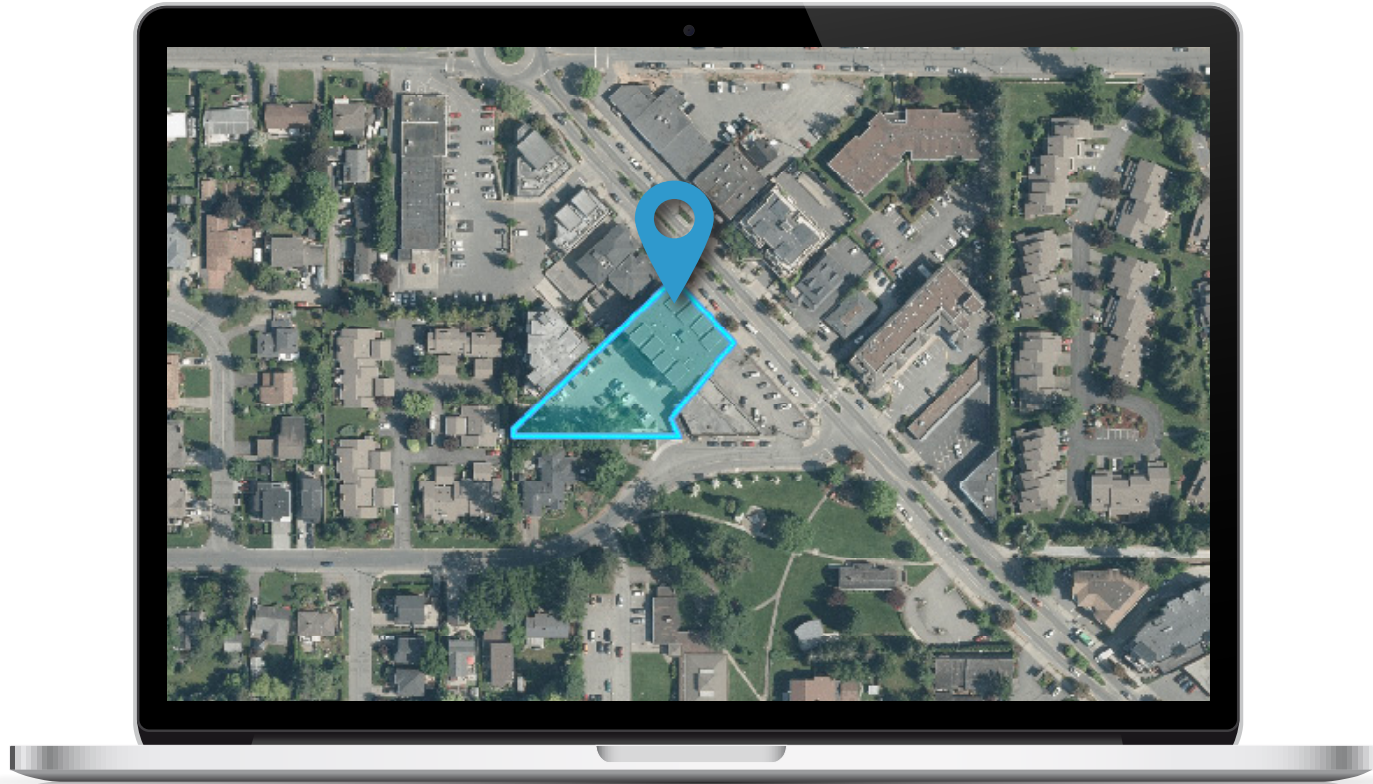



 **CHACE  
WHITSON**  
PERSONAL REAL ESTATE CORPORATION

  
**Macdonald  
Realty**



CEL · 250 818 9338 | TEL · 778 426 2262

[Chace@ChaceWhitson.com](mailto:Chace@ChaceWhitson.com) | [ChaceWhitson.com](http://ChaceWhitson.com)

2411 · Bevan Avenue Sidney, BC · V8L 4M9





**CHACE  
WHITSON**  
PERSONAL REAL ESTATE CORPORATION



Chace Whitson | 250.818.9338 | [Chace@ChaceWhitson.com](mailto:Chace@ChaceWhitson.com) | [ChaceWhitson.com](http://ChaceWhitson.com)