

9675 EIGHTH

Sidney





FOR SALE



9675 Eighth Street

Sidney

SUMMARY OVERVIEW



LISTING PRICE: \$1,290,000 +GST



LIVING AREA: 2,127 sq. ft.



BEDROOMS: 5



BATHROOMS: 4



Brand new home built by Garrett Wakefield Construction and designed by Hoyt Design. This stunning 3-bed, 3-bath residence features 1,350 sqft of open-concept living space. The main-floor primary bedroom includes a walk-in closet and spa-like en-suite. The kitchen boasts shaker cabinets, quartz countertops, and premium stainless steel appliances. Upstairs, you'll find two additional bedrooms with attic access for storage and a full bathroom. The lower floor offers a versatile 2-bed, 1-bath suite with a separate entrance. Modern amenities include an electric fireplace, engineered hardwood flooring, an electric heat pump with AC, and a tankless hot water system. Enjoy a fully fenced, professionally landscaped yard with a gas BBQ hookup. Located in charming Sidney, close to shopping, dining, and the waterfront, this home offers the best of the Saanich Peninsula lifestyle.



Property Floorplan

Main Floor 827 sq. ft.
Upper Floor 523 sq. ft.
Lower Floor 777 sq. ft.

LIVING AREA 2,127 sq. ft.

Patio 368 sq. ft.

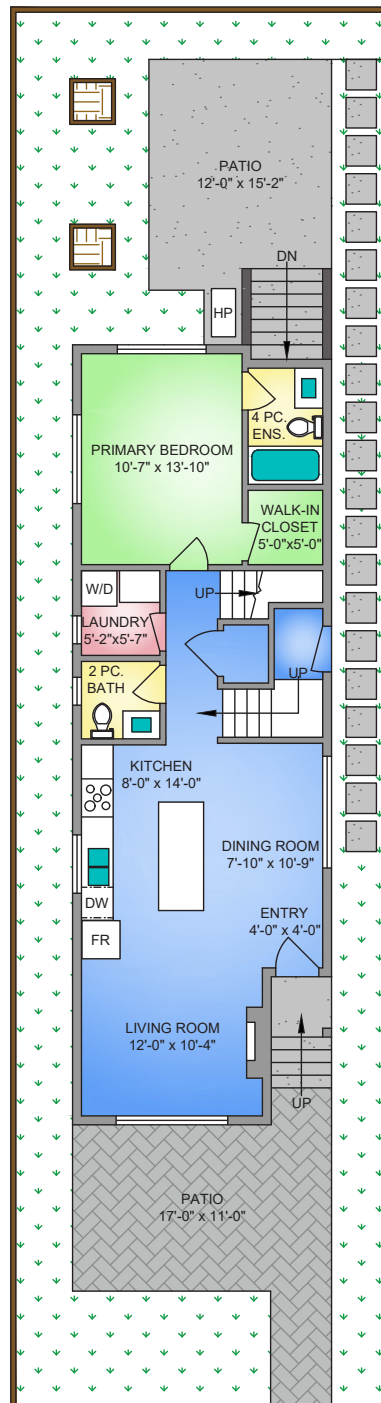

MAIN FLOOR
827 SQ. FT.
8'-0" CEILING HEIGHT

UPPER FLOOR
523 SQ. FT.
9'-0" VAULTED CEILING

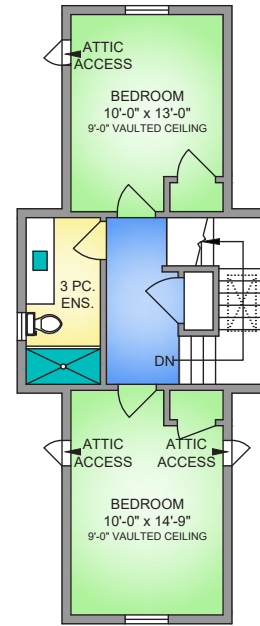

LOWER FLOOR
777 SQ. FT.
8'-0" CEILING HEIGHT

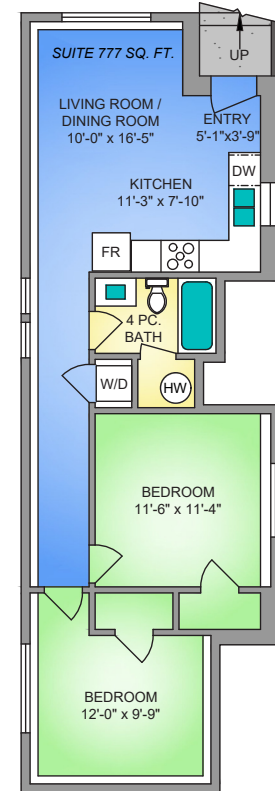

NORTH



0' 5' 10'
SCALE

* DIMENSIONS ARE FOR REFERENCE PURPOSES ONLY AND ARE NOT TAKEN FROM ORIGINAL BLUEPRINTS



Property Photos

EXTERIOR





Property Photos

INTERIOR





Property Photos

KITCHEN





Property Photos

INTERIOR





Location

(GIS) MAPPING

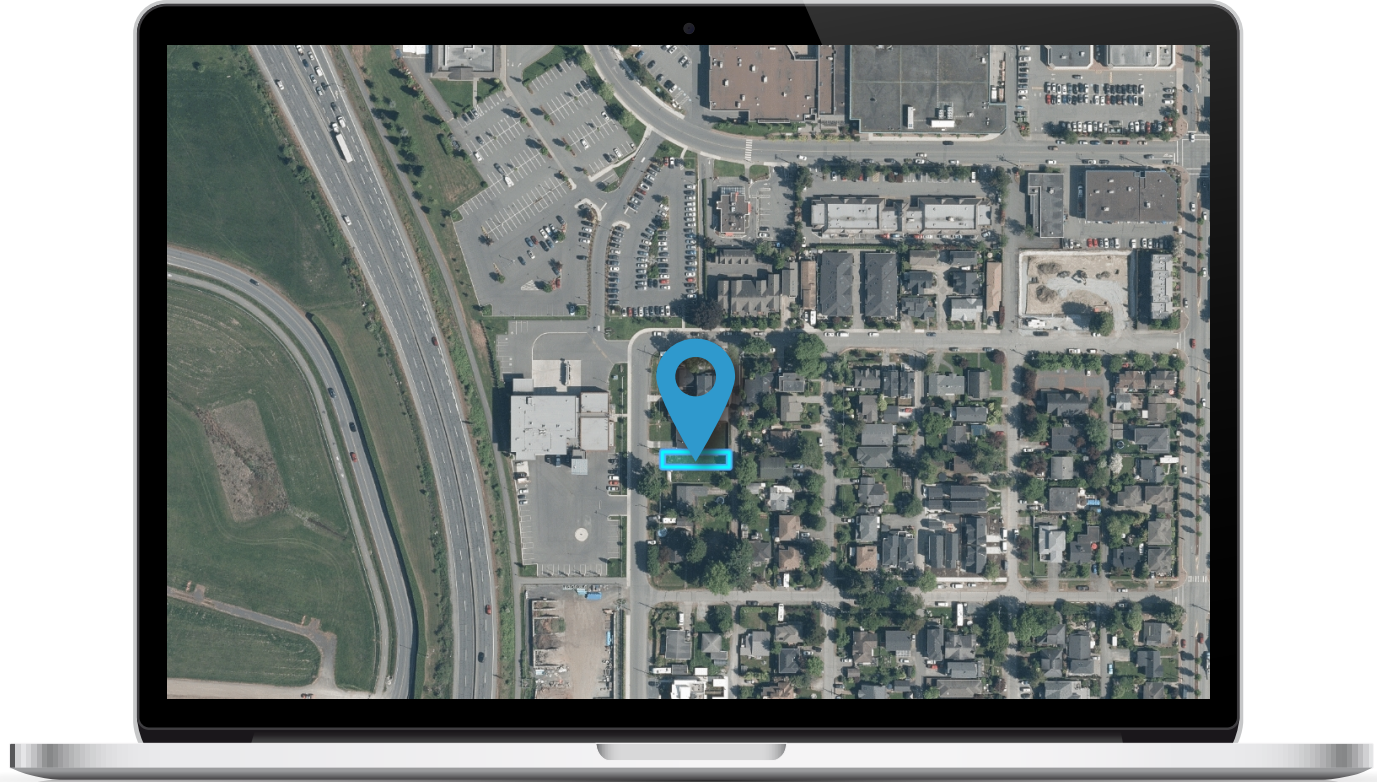



 **CHACE
WHITSON**
PERSONAL REAL ESTATE CORPORATION

Macdonald
Realty



CEL · 250 818 9338 | TEL · 778 426 2262

Chace@ChaceWhitson.com | ChaceWhitson.com

2411 · Bevan Avenue Sidney, BC · V8L 4M9





**CHACE
WHITSON**
PERSONAL REAL ESTATE CORPORATION



Chace Whitson | 250.818.9338 | Chace@ChaceWhitson.com | ChaceWhitson.com