

2271 ADELA PLACE
1838 SQ. FT.
9' CEILING HEIGHT

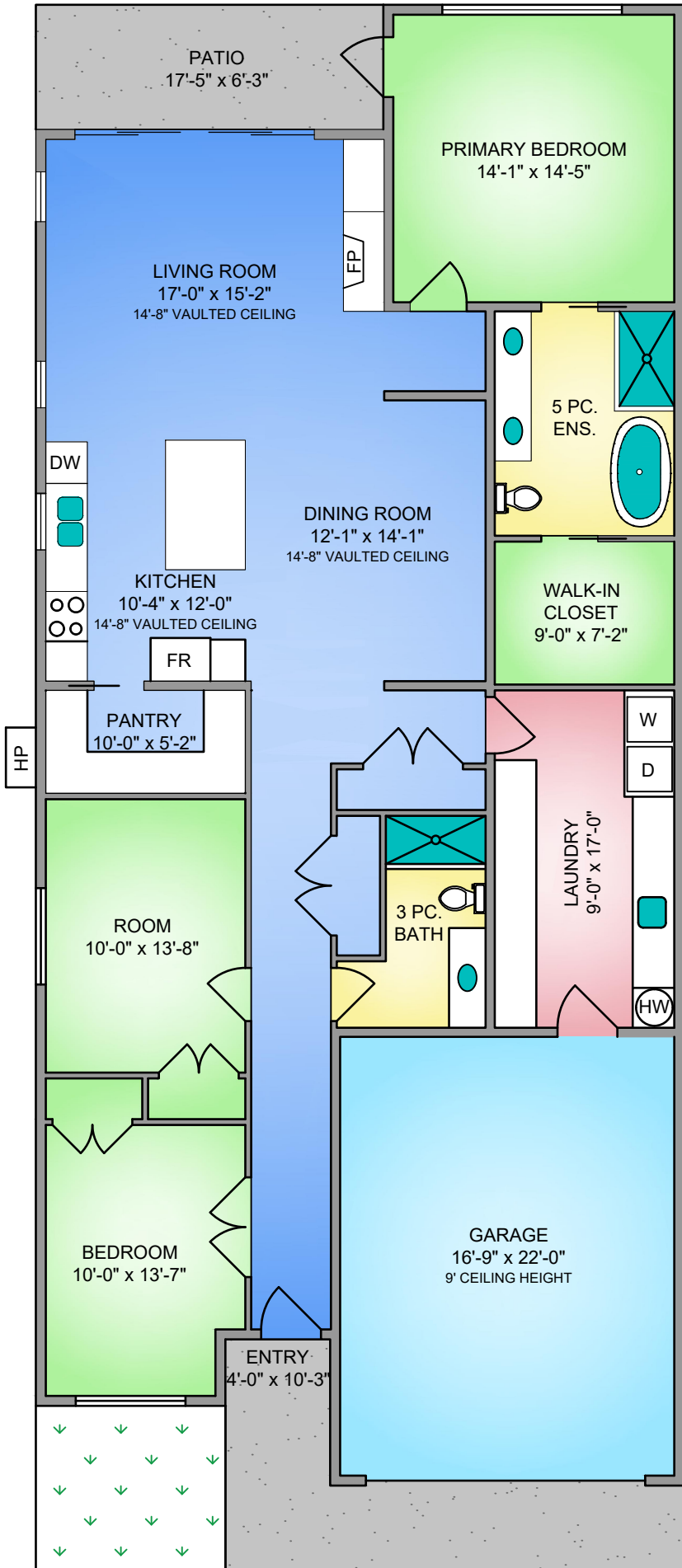

NORTH

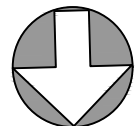
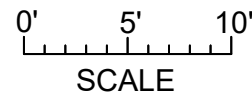

2271 ADELA PLACE JULY 15, 2024			
PREPARED FOR THE EXCLUSIVE USE OF CHACE WHITSON. PLANS ARE A REPRODUCTION OF CONSTRUCTION DRAWINGS AND MAY NOT BE 100% ACCURATE. IF CRITICAL BUYER TO VERIFY.			
FLOOR	AREA (SQ. FT.)		
	FINISHED	GARAGE	PATIO
MAIN	1838	403	109