



770 SEA DRIVE

Brentwood Bay





FOR SALE



770 Sea Drive

Brentwood Bay

SUMMARY OVERVIEW



LISTING PRICE:	\$3,600,000
LIVING AREA:	3,030 sq. ft.
BEDROOMS:	3 + Office
BATHROOMS:	3





This 3,030 sqft, 3 bed/3 bath, West Coast style oceanfront home was built with unparalleled quality and craftsmanship and showcases stunning views of Brentwood Bay. The open concept main living area features bamboo flooring, a custom kitchen with stainless steel appliances, dining area and a spacious living room with a gas fireplace. Expansive accordion-style doors open to a resort style deck with frameless railings and an overhead heater. Highlights include a 50ft private dock with foreshore lease, boathouse, 14ft boat ramp and storage for kayaks and paddle boards. Relax while enjoying stunning ocean views from the main-level primary bedroom, which also features a 5-piece en-suite and walk-in closet. The spacious lower level has 2 additional bedrooms, living space and a kitchenette. Outside, you will find a covered hot tub, fully landscaped yard, garden lighting and irrigation. Experience stunning sunsets and year-round moorage in the Saanich Inlet from this truly spectacular home.



Property Floorplan

Main Floor 1,637 sq. ft.
Lower Floor 1,393 sq. ft.
Boat House 196 sq. ft.

TOTAL AREA 3,030 sq. ft.

Garage 421 sq. ft.
Deck/Patio 846 sq. ft.

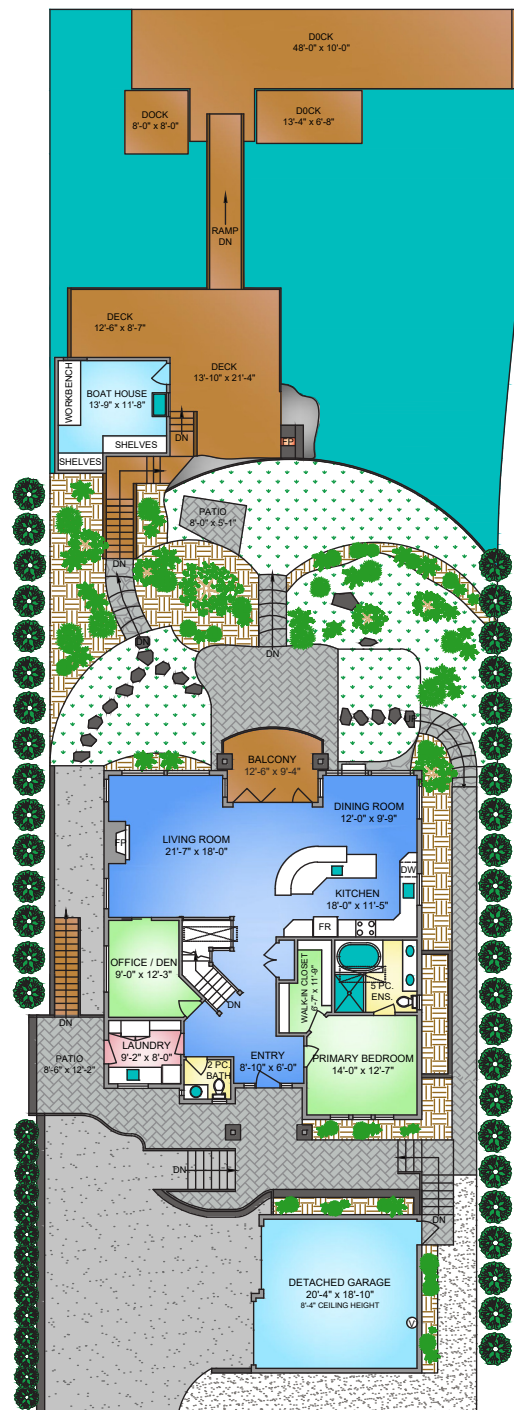

MAIN FLOOR
1637 SQ. FT.
9' CEILING HEIGHT

NORTH



0' 5' 10'
SCALE

* DIMENSIONS ARE FOR REFERENCE PURPOSES ONLY AND ARE NOT TAKEN FROM ORIGINAL BLUEPRINTS



Property Floorplan

Main Floor 1,637 sq. ft.
Lower Floor 1,393 sq. ft.
Boat House 196 sq. ft.

TOTAL AREA 3,030 sq. ft.

Garage 421 sq. ft.
Deck/Patio 846 sq. ft.

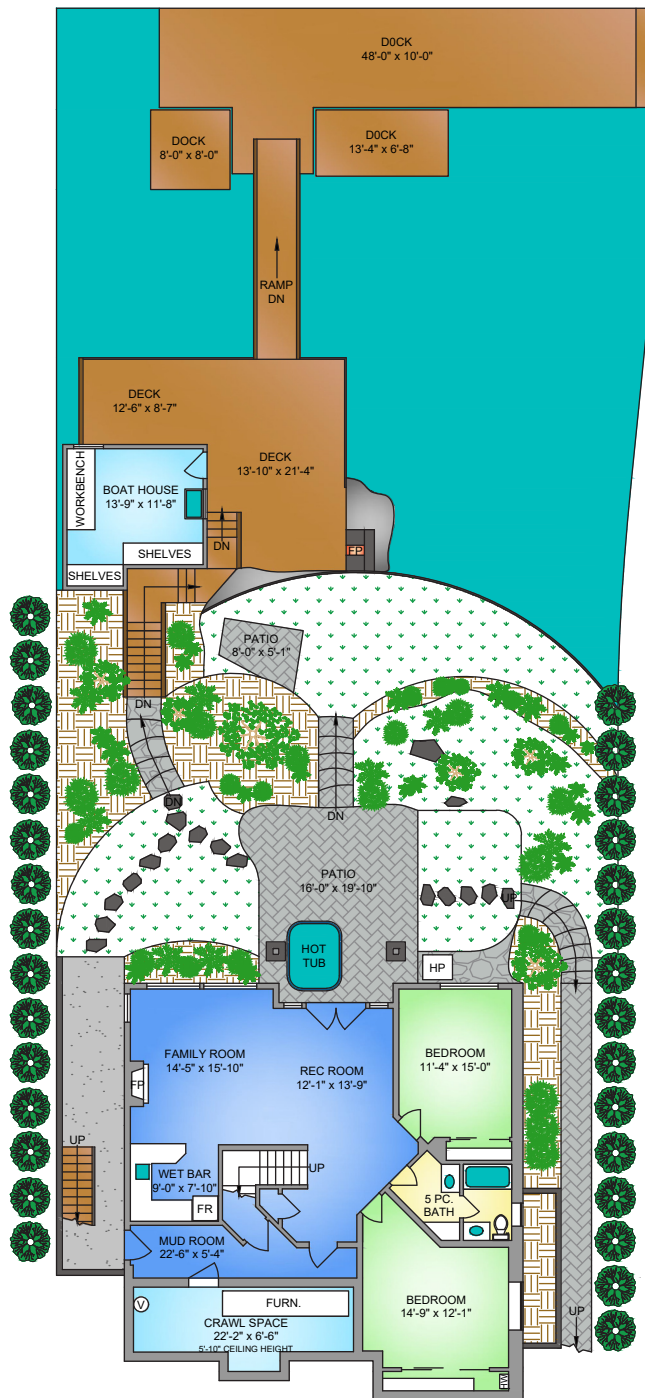

LOWER FLOOR
1393 SQ. FT.
8'-5" CEILING HEIGHT

NORTH



0' 5' 10'
SCALE

* DIMENSIONS ARE FOR REFERENCE PURPOSES ONLY AND ARE NOT TAKEN FROM ORIGINAL BLUEPRINTS



Property Photos

EXTERIOR





Property Photos

EXTERIOR





Property Photos

KITCHEN





Property Photos

INTERIOR





Property Photos

PRIMARY BEDROOM
& ENSUITE





Location

(GIS) MAPPING





 **CHACE
WHITSON**
PERSONAL REAL ESTATE CORPORATION

 **Macdonald
Realty**



CEL • 250 818 9338 | TEL • 778 426 2262

Chace@ChaceWhitson.com | ChaceWhitson.com

2411 • Bevan Avenue Sidney, BC • V8L 4M9





**CHACE
WHITSON**
PERSONAL REAL ESTATE CORPORATION



Chace Whitson | 250.818.9338 | Chace@ChaceWhitson.com | ChaceWhitson.com