

2525 BEAUFORT ROAD

Sidney





FOR SALE



2525 Beaufort Road

Sidney

SUMMARY OVERVIEW



LISTING PRICE: \$4,800,000



LIVING AREA: 4,132 sq. ft.



BEDROOMS: 4 + Office



BATHROOMS: 4



On a near acre of low bank waterfront, this home seamlessly blends its parklike setting with its breathtaking ocean backdrop. Custom built in 2008, the home offers 3300 sqft of single story, luxury living and an additional 800-sqft guest suite. Timeless details define the home, from the gated entrance and winding driveway, to the high-end finishes and architectural detailing throughout. The spacious kitchen offers panelled appliances, a wine fridge, and gas range, and sits open to the breakfast nook and family room, with spanning windows for views from every room. The primary suite included, with panoramic views, a walk-in closet, and luxe ensuite. The property is fit for any car enthusiast, with a 1500-sqft, 5-car garage as well as a detached, post and beam RV carport. Outdoors offers 1200 sqft of patio with overhead gas heaters and a glass railing for uncompromising views. Located within walking distance to beautiful, downtown Sidney, this home defines luxurious seaside living.



Property Floorplan

Main Floor 3,335 sq. ft.

Upper Floor 797 sq. ft.

TOTAL AREA 4,132 sq. ft.

Garage 1,500 sq. ft.

Carport 539 sq. ft.

Deck / Patio 1,244 sq. ft.

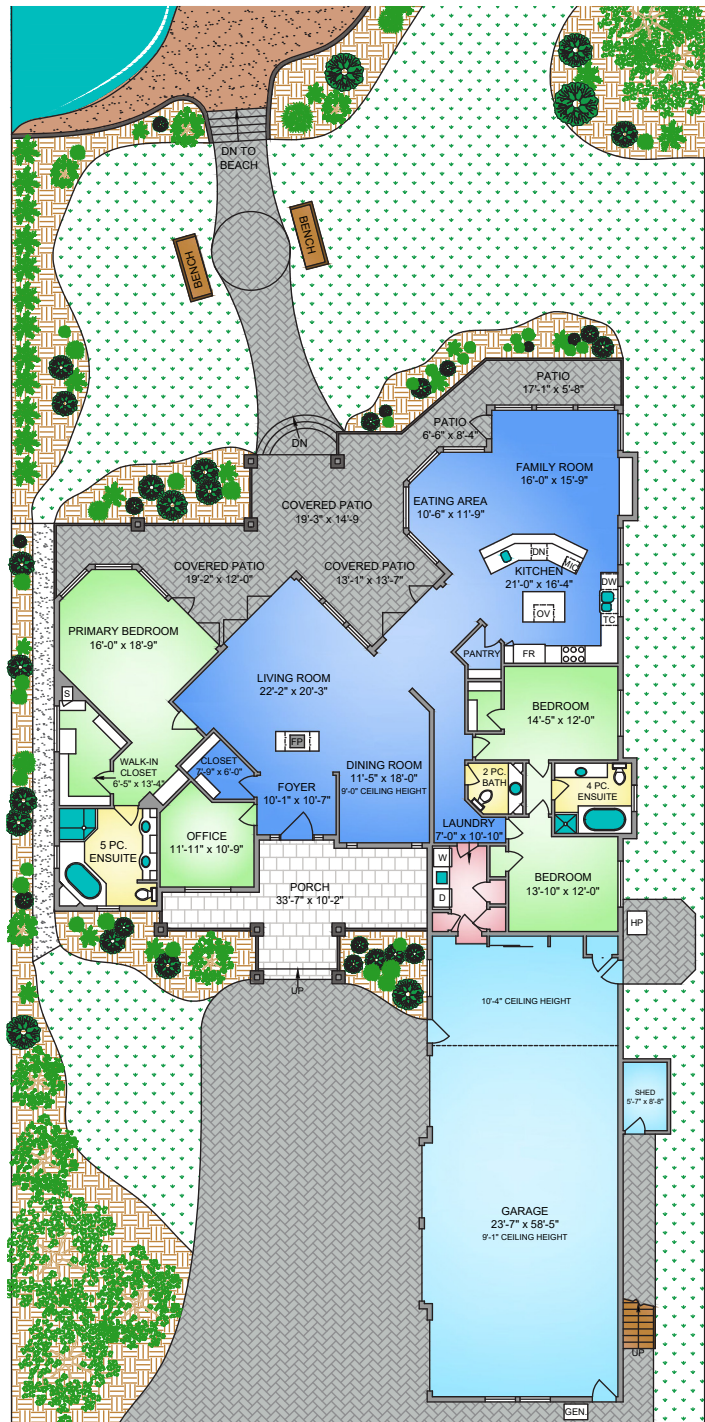

MAIN FLOOR
3335 SQ. FT.
9'-0" CEILING HEIGHT

UPPER FLOOR
797 SQ. FT.
9'-10" TO 3'-0" VAULTED CEILING



NORTH

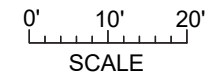

* DIMENSIONS ARE FOR REFERENCE PURPOSES ONLY AND ARE NOT TAKEN FROM ORIGINAL BLUEPRINTS



Property Photos

EXTERIOR





Property Photos

EXTERIOR





Property Photos

KITCHEN





Property Photos

INTERIOR





Property Photos

INTERIOR





Property Photos

PRIMARY BEDROOM
& ENSUITE





Location

(GIS) MAPPING





 **CHACE
WHITSON**
PERSONAL REAL ESTATE CORPORATION

 **Macdonald
Realty**



**CHACE
WHITSON**
PERSONAL REAL ESTATE CORPORATION

CEL · 250 818 9338 | TEL · 778 426 2262

Chace@ChaceWhitson.com | ChaceWhitson.com

2411 · Bevan Avenue Sidney, BC · V8L 4M9





**CHACE
WHITSON**
PERSONAL REAL ESTATE CORPORATION



Chace Whitson | 250.818.9338 | Chace@ChaceWhitson.com | ChaceWhitson.com